

LEAN-TO FRAME WITH  
MOMENT CONNECTION AT  
TOP OF COLUMN

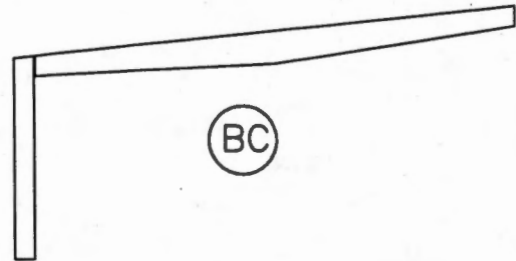

LEAN-TO FRAME WITH SHEAR  
CONNECTION AT TOP OF  
COLUMN

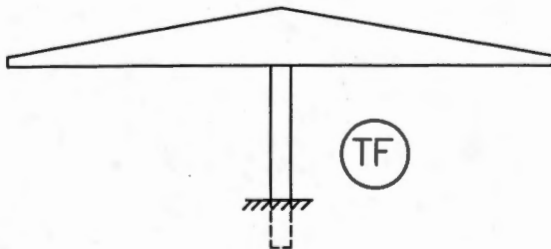

TEE FRAME

NO SUPPORT ON ENDS.  
COLUMN TO BE RECESSED  
IN CONCRETE 2' BELOW  
GRADE

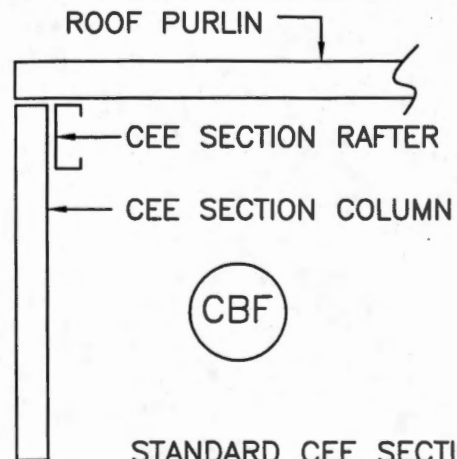

STANDARD CEE SECTION  
ENDWALL FRAMING

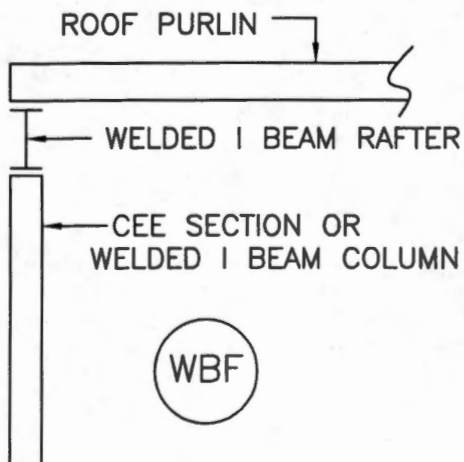

OPTIONAL ENDWALL FRAMING

- 1) INTERIOR COLUMNS MAY BE USED WITH ANY FRAME.
- 2) FRAME PROFILE SUBJECT TO CHANGE.
- 3) UNLESS SPECIFIED, FRAME DESIGN UTILIZES THE MOST ECONOMICAL METHOD OF CONSTRUCTION.
- 4) ALL FRAMES WILL HAVE A RED OXIDE FINISH OF 0.5 MIL NOMINAL THICKNESS.